

# Introducing Civacon's MaxAir™ Internal Valves...

## Maximum Performance, Maximum Value.



*Our new MaxAir™ air operated internal valves set the standard for real world performance — maximum flow characteristics and the rugged reliability, with minimal maintenance, you expect from Civacon equipment.*

*Real World, Real Value. Specify Civacon MaxAir.*

- Unique integrated design enables mounting of piston inside tank for better wear, reduced exposure to environment
- No moving parts in the flow path for superior flow rates, faster drops and maximum profits — outperforms 6" valve technology
- Exclusive TSS™ triple seal system protects piston to deliver maximum reliability, minimal maintenance
- Full-opening/full-closing seal disc operation, every time, for faster product delivery
- Cold climate field tested and rated at -40°F, plus 100,000 cycle testing assures real world reliability and maximum value
- Unique Quick-Exhaust valve bleeds residual air, limiting condensation in the air line; improves operating life
- Optional slotted mounting holes enable valve to align with existing plumbing, simplifying installation
- Pneumatic override emergency relief screw for manual operation in the event of air pressure loss or malfunction — optional pneumatic override tool available (Part#: 9430)
- Meets HM183 standards for internal valves
- Compatible with 4" TTMA sumps
- Available in a variety of configurations for standard compatibility and easy installation (*see chart on back*)
- Patent pending

For ordering information, call 888-526-5657. Or visit us on the web at [www.civacon.com](http://www.civacon.com).

**REAL WORLD. REAL SOLUTIONS.  
THAT'S CIVACON.**

**civacon**

a division of... **TRANSFER CONTROL**  
technologies

4304 Mattox Road • Riverside, MO 64150  
816-741-6600 • fax 816-741-1061

[www.civacon.com](http://www.civacon.com)

**ISO 9001**  
certified

# Civacon MaxAir™ Air Operated Internal Valve

## PARTS LIST FOR TYPICAL VA5142

ITEM	PART#	DESCRIPTION
1	6963	Valve Body (elbow, Victaulic)
2	6951	Cylinder Disk (aluminum)
3	6962	Seal Washer (Buna/plated steel)
4	6953	Stem (303 stainless steel)
5	5687	Hex Jam Nut (plated steel)
6	6954	Piston (aluminum)
7	6957	Cap (aluminum)
8	6956	Hex Cap Screw (plated steel)
9	9052	1/4" Exhaust Tubing
10	6950	Cylinder Body (anodized aluminum)
11	6959	O-Ring (TFE-O-Sil)
12	6234	Spring (outer)
13	6233	Spring (inner)
14	6960	Seal Washer (Buna /pld. steel)
15	5865	U-Cup Seal (Buna)
16	6966	Energized U-Cup Seal (Teflon)
17	6969	O-Ring (Viton)
18	6965	Seal Screw (pld. 1/4 — 20 x 1/2)
19	5047	Fusible Plug
20	6633	Lock Washer (plated steel)
21	6967	Screw 1/4 — 20 x 1, 1/2 FI Thd
22	9054	Elbow Male 1/8 NPT
23	9050	1/4" Quick Exhaust Valve
24	9102	Clamp 1/2" Nylon
25	9091	Clamp 7/16" Nylon
26	9051	1/4" Outlet Tubing
27	9103	Screw 8 — 32 x 3/8" Lg Ext. Sems
28	9059	1/4" Nipple
29	9053	Elbow Female 1/8" NPT
30	6964	O-Ring (Viton)
31	6961	O-Ring (Buna)

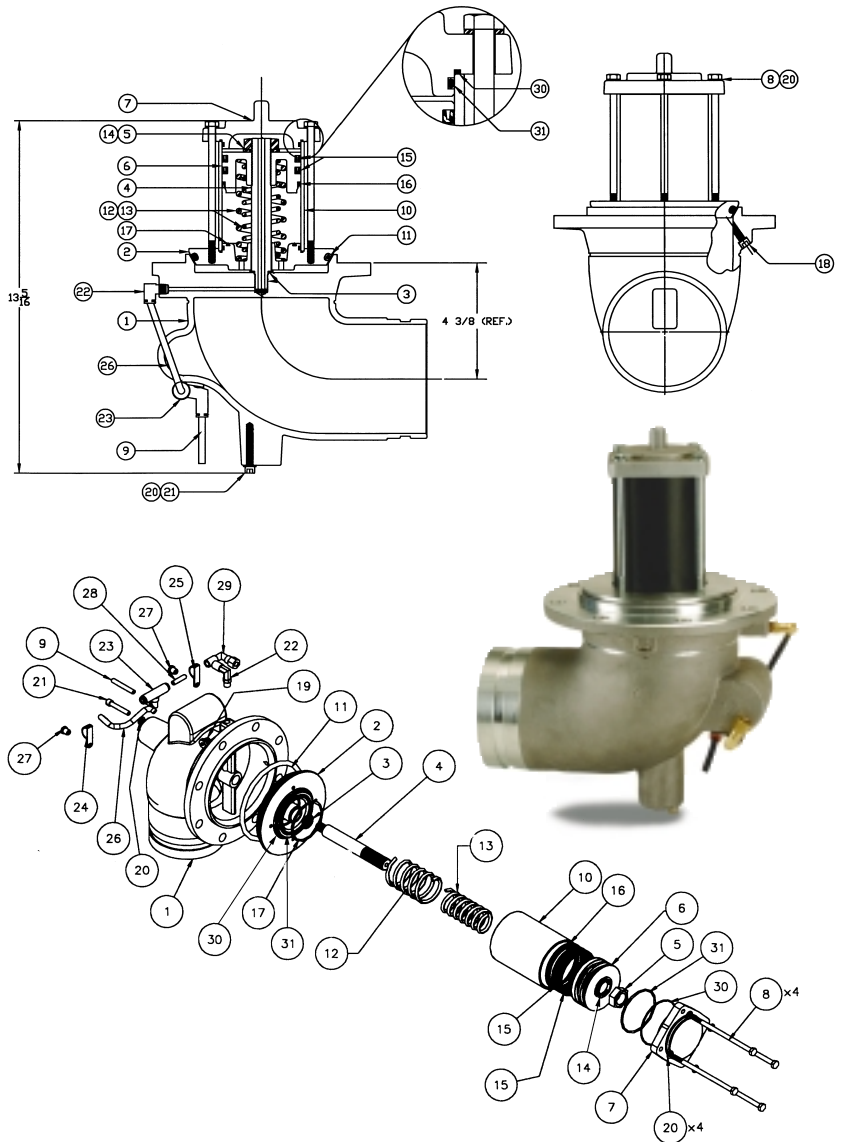

## MAXAIR AIR OPERATED INTERNAL VALVE ORDERING INFORMATION

TYPE	CODE	BODY	CODE	OPERATION	CODE	SEAL
VA	51	90° Elbow/Victaulic	4	Internal Air	1	Viton*
	61	90° Elbow/Flanged	4		2	Tef-Sil
	71	Straight/Victaulic	4		3	Kalrez*
	81	Straight/Flanged	4		4	Nitrile*

Use suffix "S" for slotted mounting holes configuration

*e.g. VA5142S = 90° Elbow/Victaulic, MaxAir air operated internal valve with slotted mounting holes and Tef-Sil seal*

Approximate weights: MaxAir Elbow = 11.20 lbs.; MaxAir Straight = 8.95 lbs

\*Please contact Civacon for availability



**civacon**™

a division of... **TRANSFER CONTROL**  
technologies

4304 Mattox Road • Riverside, MO 64150  
816-741-6600 • fax 816-741-1061  
www.civacon.com

ISO 9001  
certified

FOR MAXAIR™ INTERNAL VALVE PARTS  
AND PURCHASING INFORMATION,  
CALL 888-526-5657.

**REAL WORLD. REAL SOLUTIONS.  
THAT'S CIVACON.**